

# IMPACT WRENCHES



A professional range of Impact Wrenches for powerful, speedy and durable performance thereby improving productivity

Impact Wrenches are the most important tools in automotive and industrial applications. They are used for tightening and loosening of nuts & bolts in tyre removal, suspension, transmission, air conditioning, engine repair, body shop work, assembly lines as well as general plant maintenance



WATCH VIDEO

## Mechanisms



### ROCKING DOG MECHANISM

Ideal for optimum power transmission and constant torque output



### JUMBO HAMMER MECHANISM

Simplest technology which produces high torque instantly for tough applications

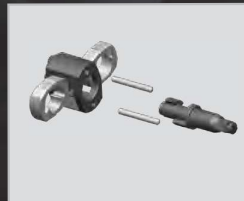

### TWIN HAMMER MECHANISM

Balanced & powerful mechanism comprising of two fully forged hammers that work alternatively. With lower air consumption & low reaction force the system builds up torque smoothly, to its maximum level

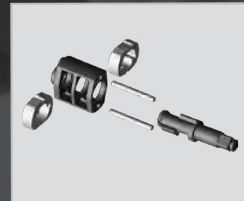

### IMPROVED TWIN HAMMER MECHANISM

Designed for higher torque & durability. Strong reinforced hammer frame can take higher impact for a longer time. Larger anvil provides a large contact area. Gives 25% more torque compared to twin hammer & enhances tool life by upto 3 times



### PIN-LESS CLUTCH MECHANISM

High torque output with excellent power to weight ratio & fast run down for less frequent high torque applications

## Air Exhaust



### FRONT EXHAUST

Air is blown forward towards the working area. This is normally found in the simpler design models



### REAR EXHAUST

This is the most popular design. Air is discharged down the handle and blown away from the working area



### SIDE EXHAUST

The air is discharged from the side of the tool



### 360° EXHAUST

Air can be blown in any desired direction by rotating the exhaust disk

## Handle Type



### PISTOL TYPE



### STRAIGHT D-HANDLE TYPE

# IMPACT WRENCHES



**IPW - 201**



**IPW - 202**



Forward reverse control



CONSTRUCTION	Aluminium	Composite
GRIP	-	<b>TPR Grip</b>
MECHANISM	Jumbo Hammer	Twin Hammer
MAX. TORQUE *@15SEC	<b>360 Nm</b>	<b>745 Nm</b>
FREE SPEED	10,000 RPM	13,500 RPM
EXHAUST	Rear Exhaust	Rear Exhaust
AIR INLET SIZE	1/4"	1/4"
AIR HOSE I.D.	3/8"	3/8"
AVG. AIR CONSUMPTION	71 LPM (2.5 CFM)	167 LPM (5.9 CFM)
MAX. NUT CAPACITY	M11	M14
NET WT.	<b>1.35 KG</b>	<b>1.23 KG</b>
OVERALL LENGTH	5-1/2" (140mm)	6" (152mm)
APPLICATION	<ul style="list-style-type: none"> <li>Tyre services &amp; wheel alignment</li> <li>Repair of white goods (fans, washing machines etc.)</li> </ul>	<ul style="list-style-type: none"> <li>General Repair, transmission work, exhaust system and body shop for 2 &amp; 3 wheelers</li> <li>Repair of white goods (fans, washing machines etc.)</li> </ul>
USAGE INTENSITY	<b>INTENSIVE</b>	<b>INTENSIVE</b>
SPEED CONTROL	 <p><b>5 speed position control</b></p>	 <p><b>4 speed positive control, full Power in reverse</b></p>

**13**

## 1/2" Drive Angle Impact Wrench

**IPW-300 SERIES**

Special stubby style wrench with long handle ideal for use in confined spaces

Reduced vibrations(50%) & increased torque (20%) compared to other geared angle impact wrenches



360° Swivelling Exhaust

**IPW - 307**
**NEW!**



SCAN TO  
WATCH

**CE**

3.4" (88 mm)



9.7" (248 mm)

CONSTRUCTION	Aluminium
GRIP	-
MECHANISM	Jumbo Hammer
MAX. TORQUE *@15SEC	<b>678 Nm</b>
FREE SPEED	6,500 Rpm
EXHAUST	360° Swivelling Exhaust
AIR INLET SIZE	1/4"
AIR HOSE I.D.	3/8"
AVG. AIR CONSUMPTION	119 LPM (4.2 CFM)
MAX. NUT CAPACITY	M16
NET WT.	<b>1.4 KG</b>
OVERALL LENGTH	9.76" (248mm)
APPLICATION	<ul style="list-style-type: none"> <li>• General Automotive Repair &amp; Service Center For Passenger Vehicles</li> <li>• MRO Jobs In Railways</li> <li>• Repair &amp; Maintenance Of Gear Units &amp; Boxes</li> <li>• Repair &amp; Maintenance Of Printing Press Machines</li> </ul>
USAGE INTENSITY	<b>INTENSIVE</b>
SPEED CONTROL	 <p><b>3 speed position control, full power in reverse positive</b></p>

**IPW - 301**



**IPW - 302**

**NEW!**



CONSTRUCTION	Aluminium	Aluminium
GRIP		
MECHANISM	Twin Hammer	Rocking Dog
MAX. TORQUE *@15SEC	<b>1223 Nm</b>	<b>500 Nm</b>
FREE SPEED	8,000 RPM	7,000 RPM
EXHAUST	Front Exhaust	Front Exhaust
AIR INLET SIZE	1/4"	1/4"
AIR HOSE I.D.	3/8"	3/8"
AVG. AIR CONSUMPTION	113 LPM (4 CFM)	141 LPM (5 CFM)
MAX. NUT CAPACITY	M16	M14
NET WT.	<b>2.56 KG</b>	<b>2 KG</b>
OVERALL LENGTH	6.7" (171mm)	7" (180mm)
APPLICATION	<ul style="list-style-type: none"> <li>Maintenance &amp; repair of Passenger Vehicles</li> <li>Railways</li> <li>Gear Units &amp; Gear Boxes</li> <li>Printing Press Machines</li> <li>Assembly line of white goods (Fans, washing machines etc.)</li> </ul>	<ul style="list-style-type: none"> <li>Ideal for use in 2 wheeler industry for repairs such as tyre-changing and maintenance applications</li> </ul>
USAGE INTENSITY	<b>INTENSIVE</b>	<b>OCCASIONAL</b>
SPEED CONTROL	 <p><b>6 speed position control</b></p>	 <p><b>4 speed position control</b></p>

**IPW-300 SERIES**



**IPW - 304**



Forward  
reverse  
control



**IPW - 305**



**IPW - 306**

**NEW!**





Composite	Composite	Composite
<b>TPR Grip</b>		<b>TPR Grip</b>
Twin Hammer	Twin Hammer	Twin Hammer
<b>1492 Nm</b>	<b>1356 Nm</b>	<b>1200 Nm</b>
8,500 RPM	6,000 RPM	7,500 RPM
Rear Exhaust	Rear Exhaust	Rear Exhaust
1/4"	1/4"	1/4"
3/8"	3/8"	3/8"
190 LPM (6.7 CFM)	207 LPM (7.3 CFM)	184 LPM (6.5 CFM)
M19	M22	M16
<b>1.9 KG</b>	<b>2.3 KG</b>	<b>2.1 KG</b>
7.2" (185mm)	7.5" (190mm)	7.2" (185mm)
<ul style="list-style-type: none"> <li>• General automotive repair &amp; service center for passenger vehicles</li> <li>• MRO jobs in railways</li> <li>• Repair &amp; maintenance of gear units &amp; boxes</li> <li>• Repair &amp; maintenance of printing press machines</li> </ul>	<ul style="list-style-type: none"> <li>• General automotive repair &amp; service center for passenger vehicles</li> <li>• MRO jobs in railways</li> <li>• Repair &amp; maintenance of gear units &amp; boxes</li> <li>• Repair &amp; maintenance of printing press machines</li> </ul>	<ul style="list-style-type: none"> <li>• Four-wheeler workshops for general automotive repair &amp; service centers for passenger vehicles</li> <li>• Gear units and printing press machines for repair &amp; maintenance</li> </ul>
<b>INTENSIVE</b>	<b>MEDIUM</b>	<b>OCCASIONAL</b>
 <p><b>4 speed positive control, full power in reverse</b></p>	 <p><b>3 speed position control, full power in reverse</b></p>	 <p><b>3 speed position control Full Power in reverse</b></p>

**IPW - 401**

**CE**
**IPW - 402**

**CE**

CONSTRUCTION	Aluminium	Composite
GRIP	-	-
MECHANISM	Improved Twin Hammer	Improved Twin Hammer
MAX. TORQUE *@15SEC	<b>2522 Nm</b>	<b>2305 Nm</b>
FREE SPEED	6,700 RPM	6,000 RPM
EXHAUST	Rear Exhaust	Rear Exhaust
AIR INLET SIZE	1/4"	3/8"
AIR HOSE I.D.	3/8"	1/2"
AVG. AIR CONSUMPTION	198 LPM (7 CFM)	207 LPM (7.3 CFM)
MAX. NUT CAPACITY	M24	M26
NET WT.	<b>4.75 KG</b>	<b>4.19 KG</b>
OVERALL LENGTH	9.2" (235mm)	8.7" (222mm)
APPLICATION	<ul style="list-style-type: none"> <li>MRO jobs in oil &amp; gas industry</li> <li>MRO jobs in paper processing plants</li> </ul>	<ul style="list-style-type: none"> <li>MRO jobs in oil &amp; gas industry</li> <li>MRO jobs in paper processing plant</li> </ul>
USAGE INTENSITY	<b>INTENSIVE</b>	<b>MEDIUM</b>
SPEED CONTROL	 <p><b>3 speed positive control, full power in reverse</b></p>	 <p><b>3 speed position control, full power in reverse</b></p>



**16**
**1" Drive  
D-Handle Impact Wrench**
**IPW-500 SERIES**

**IPW - 501**

6" (150 mm) Anvil

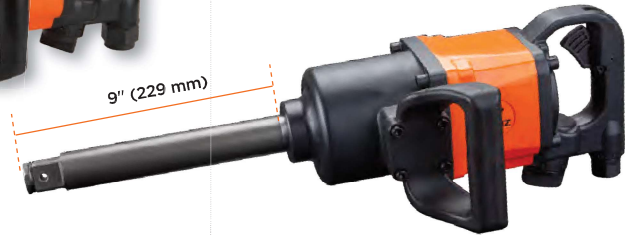
**IPW - 502**



9" (229 mm)

**CE**

CONSTRUCTION	Aluminium	Aluminium
GRIP	-	-
MECHANISM	Pin-less Clutch	Twin Hammer
MAX. TORQUE *@15SEC	<b>2522 Nm</b>	<b>2400 Nm</b>
FREE SPEED	4,000 RPM	3,500 RPM
EXHAUST	Side Exhaust	Side Exhaust
AIR INLET SIZE	1/2"	1/2"
AIR HOSE I.D.	3/4"	1/2"
AVG. AIR CONSUMPTION	238 LPM (8.4 CFM)	247 LPM (8.7 CFM)
MAX. NUT CAPACITY	M38	M32
NET WT.	<b>12.06 KG</b>	<b>11 KG</b>
OVERALL LENGTH	20.3" (515mm)	23.2" (590mm)
APPLICATION	<ul style="list-style-type: none"> <li>Truck garages, construction &amp; mining equipment where huge impact power is required</li> <li>Erection &amp; commissioning of heavy equipment in power plants, sugar mill, cement plants &amp; steel mills</li> <li>MRO jobs in shipping Wards</li> <li>Routine maintenance of wind mills</li> </ul>	<ul style="list-style-type: none"> <li>Truck garages, construction &amp; mining equipment where huge impact power is required</li> <li>Erection &amp; commissioning of heavy equipment in power plants, sugar mill, cement plants &amp; steel mills</li> <li>MRO jobs in shipping Wards</li> <li>Routine maintenance of wind mills</li> </ul>
USAGE INTENSITY	<b>INTENSIVE</b>	<b>OCCASIONAL</b>
SPEED CONTROL	 <p><b>3 speed position control</b></p>	 <p><b>3 speed position control</b></p>

**IPW - 503**
**NEW!**

**CE**

CONSTRUCTION	Composite
GRIP	-
MECHANISM	Improved Twin Hammer
MAX. TORQUE *@15SEC	<b>2305 Nm</b>
FREE SPEED	6,000 RPM
EXHAUST	Rear Exhaust
AIR INLET SIZE	3/8"
AIR HOSE I.D.	1/2"
AVG. AIR CONSUMPTION	207 LPM (7.3 CFM)
MAX. NUT CAPACITY	M26
NET WT.	<b>4.24 KG</b>
OVERALL LENGTH	8.7" (222mm)
APPLICATION	<ul style="list-style-type: none"> <li>• Truck garages, construction &amp; mining equipment where large impact power is required</li> <li>• Erection &amp; commissioning of heavy equipment in power plants, sugar mill, cement plants &amp; steel mills</li> <li>• MRO jobs in shipping wards</li> <li>• Routine maintenance of wind mills</li> </ul>
USAGE INTENSITY	<b>MEDIUM</b>
SPEED CONTROL	 <p><b>3 speed position control, full power in reverse</b></p>

**18**
**3/8" Drive  
Ratchet Wrench**
**RTW-200 SERIES**

**RTW - 201**
**CE**

CONSTRUCTION	Aluminium
MAX. TORQUE *@15SEC	<b>68 Nm</b>
FREE SPEED	150 RPM
AIR INLET SIZE	1/4"
AIR HOSE I.D.	3/8"
AVG. AIR CONSUMPTION	170 LPM (6CFM)
MAX. NUT CAPACITY	M6
NET WT.	<b>1.17 KG</b>
OVERALL LENGTH	10.5" (267mm)
APPLICATION	<ul style="list-style-type: none"> <li>Body shop repair jobs and light duty work under the dashboard</li> </ul>
USAGE INTENSITY	<b>INTENSE</b>

**19**
**1/2" Drive  
Ratchet Wrench**
**RTW-300 SERIES**
**RTW - 301**
**CE**

CONSTRUCTION	Aluminium
MAX. TORQUE *@15SEC	<b>68 Nm</b>
FREE SPEED	150 RPM
AIR INLET SIZE	1/4"
AIR HOSE I.D.	3/8"
AVG. AIR CONSUMPTION	170 LPM (6CFM)
MAX. NUT CAPACITY	M6
NET WT.	<b>1.17 KG</b>
OVERALL LENGTH	10.5" (267mm)
APPLICATION	<ul style="list-style-type: none"> <li>Body shop repair jobs and light duty work under the dashboard</li> </ul>
USAGE INTENSITY	<b>INTENSE</b>

